

FRED

Front Attached 30' | Single Family Home



Features

- Dual Access Bathroom
- Open to Above Great Room
- Uncovered Balcony
- Main Floor Bedroom / Den
- Bonus Room
- Upper Floor Laundry
- 9' Ceilings
- Covered Lower Deck
- Spice Kitchen
- Triple Attached Garage

5 Bedrooms | 4.5 Baths | 2,752 Total Sq. Ft. | 704 Total Sq. Ft.

1,266

Main Floor Sq. Ft.

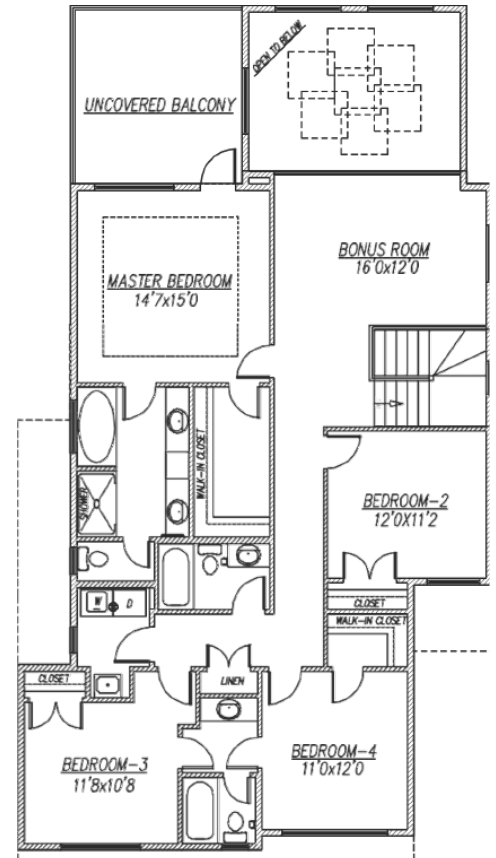
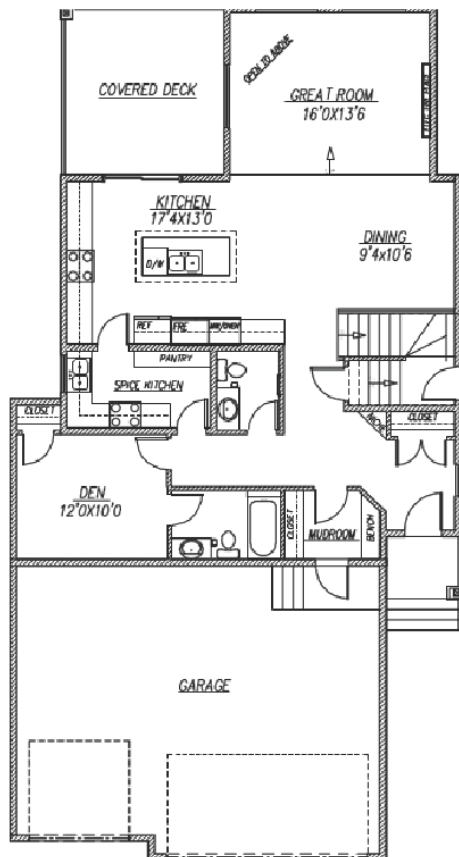

1,486

Upper Floor Sq. Ft.



587-524-1131 | sales@activehomes.ca

ActiveHomes.ca